

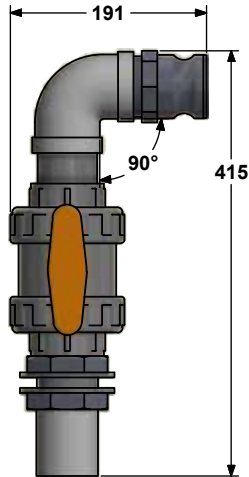

ACCESSORIES

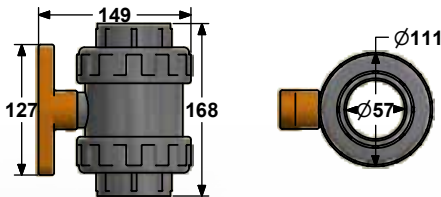

Description	Height (mm)	Length (mm)
2" Offset Fill Connection	415	192



Description	Internal $\varnothing$ (mm)	External $\varnothing$ (mm)
2" BSP Ball Valve	57	111

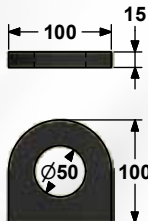

Description	Hole $\varnothing$ (mm)	Height (mm)
Lifting Hook	50	100

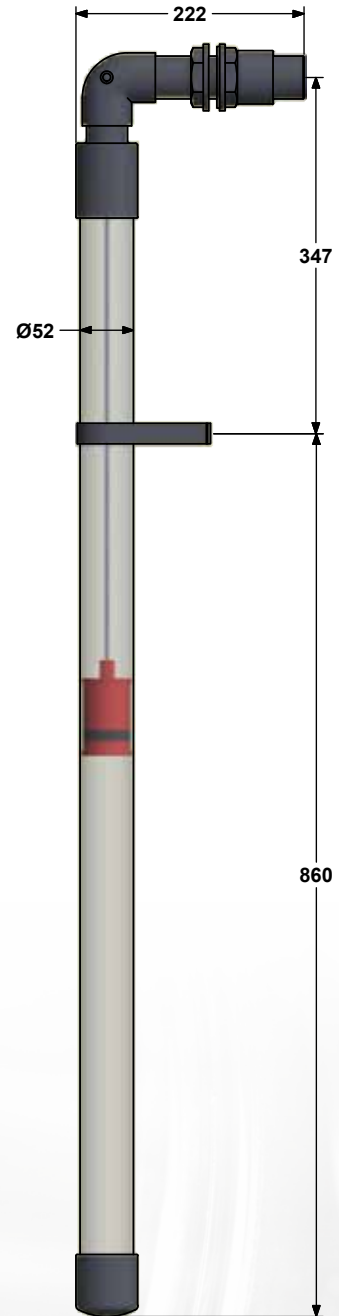

Cat & Mouse Gauge available to suit all models. Please specify tank model reference when placing your enquiry.

**Additional accessories available to suit customer specific requirements. Contact us to confirm availability and pricing.**

**Installation & Siting Guidelines**

Carbery Tanks must only be installed and commissioned by a suitably competent person in accordance with supplied instructions and all prevailing statutory requirements.

Please Consult the Installation, Operation and Maintenance Manual for further information.

Note: Dimensions are for guidance only, may vary marginally.

**Certification**

All Carbery Plastics LTD Chemical Tanks are certified to Kiwa BRL-K21008/02